

MA6432 Series Stainless Steel Mini Cylinder(ISO6432)



MA6432 10 x 50

MA6432 25 x 50

MA6432-F 25 x 40

Ordering Code

MA6432 □ 20 × 50 - 25 S □

Series Code

MA:Double Action Type
MSA:Single-Extrusion Type
MTA:Single Drawing-in Type
MAD:Double-shaft Double ActionType
MACD:Double-shaft Double Action Damping Type
MAJ:Double-shaft and adjustable stroke type
MAC:With Cushion Type

Back Cover Type

Blank:Fishtail Type
CM:Rounded Type
U:Horizontal Type
F: Copper Bush Type

Cylinder Bore

8mm-25mm

Stroke

Adjustable Stroke Type

0~100mm

Magnet Code

Blank:Without Magnet
S:With Magnet

Fixed Type

Blank:Normal type
LB:Front and back fixed type
FA:Front cover fixed type
SDB:Back cover swinging type
U:Back cover fixed type

Internal structure

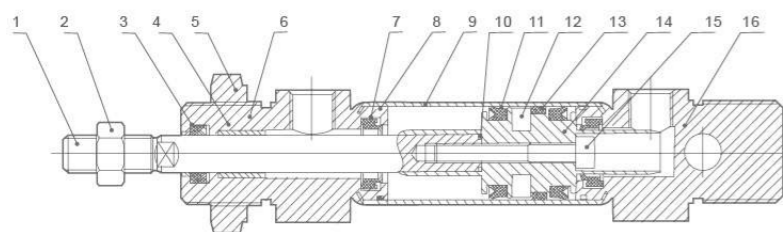

NO	Designation	NO	Designation
1	Piston Rod	9	Barrel
2	Piston Rod Nut	10	Piston rod O-ring
3	Front Cover Seal	11	Piston O-ring
4	Bearing	12	Magnet(Optional)
5	Hexagon Screw	13	Wear Ring
6	Front Cover	14	Piston
7	Cushion Ring	15	Hex Socket Screw
8	O-ring	16	Back Cover

Specification

Bore(mm)	8	10	12	16	20	25
Fluid	Air					
Motion pattern	Double Action or single Action					
Ensured Pressure Resistance	15.3kgf/cm ² (1.5Mpa)					
Max.pressure	10.2kgf/cm ² (1.0Mpa)					
Min.pressure	0.5kgf/cm ² (0.05Mpa) 1kgf/cm ² (0.1Mpa)					
Environment and fluid temp	-10~+80°C (Internal Magnetic Install by Tach strap:Type Max:60°C)					
Piston velocity	Rubber Buffer(Standard),Air Buffer(Optional)					
Buffering	50~750mm/s					
Kinetic energy Tolerance(kgf/cm)	0.2	0.3	0.4	0.9	2.7	4
Port Size	M5×0.8				G1/8"	

Stroke

Bore(mm)	Standard Stroke	Max.Stroke(mm)
8	10,25,40,50,80,100,125,160,200	400
10	10,25,40,50,80,100,125,160,200	400
12	10,25,40,50,80,100,125,160,200	400
16	10,25,40,50,80,100,125,160,200	400
20	25,40,50,80,100,125,150,160,175,200,250,300	1000
25	25,40,50,80,100,125,150,160,175,200,250,300	1000

MA6432 Series Stainless Steel Mini Cylinder(ISO 6432)

Overall Dimensions

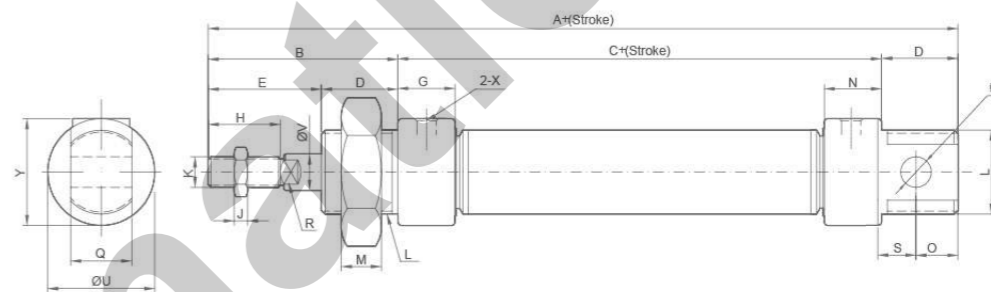

Dimension Sheet

Bore/Symbol	A	B	C	D	E	G	H	M	J	O	K	N	P	S	R	U	V	Q	Y	L	X
8	86	28	46	12	16	9	12	7	3	10	M4×0.7	9	4	6	-	15	4	8	15	M12×1.5	M5
10	86	27	47	12	15	9	12	7	3	10	M4×0.7	9	4	6	-	15	4	8	15	M12×1.5	M5
12	105	37	51	17	20	9	16	6	4.5	14	M6×1	9	6	9	5	20	6	12	20	M16×1.5	M5
16	111	38	56	17	21	12.5	16	6	4.5	13	M6×1	10.5	6	9	5	20	6	12	20	M16×1.5	M5
20	128	45	63	20	25	15	20	8	6	11	M8×1.25	15	8	12	6	27	8	16	27	M22×1.5	G1/8"
25	137	50	65	22	28	15	22	8	6	11	M10×1.25	15	8	12	8	27	10	16	27	M22×1.5	G1/8"

MA6432-N Series Stainless Steel Mini Cylinder (ISO 6432)



MA6432-N25 x 150

Overall Dimensions

Non Magnet Inside Magnet Rubber Buffer

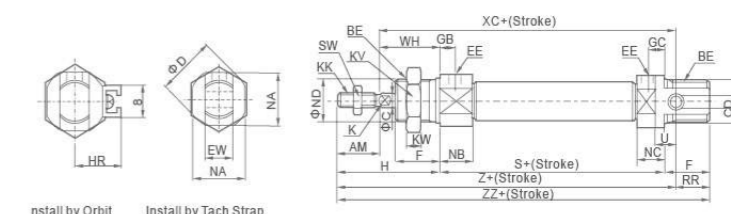

Non Magnet Inside Magnet Rubber Buffer

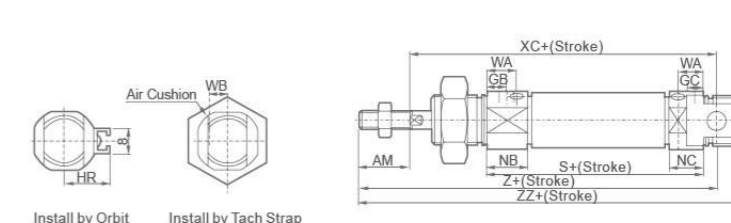

Dimension Sheet

Bore	AM	BE	ΦC	ΦCD	ΦD	EE	EW	F
Φ8	12	M12×1.25	4	4	17	M5×0.8	8	12
Φ10	12	M16×1.25	4	4	17	M5×0.8	8	12
Φ12	16	M16×1.5	6	6	20	M5×0.8	12	17
Φ16	16	M16×1.5	6	6	20	M5×0.8	12	17
Φ20	20	M22×1.5	8	8	28	G1/8"	16	20
Φ25	22	M22×1.5	10	8	33.5	G1/8"	16	22

Bore	GB	GC	WA	WB	H	HR	K	KK	KV	KW	NB	NC	NA	ΦND	RR	S	SW	U	WH	XC	Z	ZZ
Φ8	7	5	-	-	28	10	-	M4×0.7	19	6	11.5	9.5	15	12	10	46	7	6	16	64	76	86
Φ10	7(5.5)	7(5.5)	10.5	4.5	28	10.5	-	M4×0.7	19	6	11.5(13.5)	9.5(13.5)	15	12	10	46(53)	7	6	16	64(71)	76(83)	86(93)
Φ12	8(5.5)	6(5.5)	9.5	5.5	38	14	5	M6×0.8	24	8	12.5(12.5)	10.5(12.5)	18	16	14	50(54)	10	9	22	75(79)	91(95)	105(109)
Φ16	8(5.5)	6(5.5)	9.5	5.5	38	14	5	M6×0.8	24	8	12.5	10.5(12.5)	18	16	13	56	10	9	22	82	98	111
Φ20	8	8	17	8.5	44	17	6	M8×1.25	32	11	15	15	24	22	11	62	13	12	24	95	95	126
Φ25	8	8	20	10	50	20	8	M10×1.25	32	11	15	15	30	22	11	65	17	12	28	104	126	137

Our company can also provide SMC Type ISO6432 standard stainless steel mini cylinder, if you need this, pls add-N after normal ordering code.

MA6432 Series Stainless Steel Mini Cylinder (ISO 6432 Big Bore)



MAC6432 50 x 50-S



MAC6432 63 x 50-S

Ordering Code

MA6432 □ 50 × 50 - 25 - S - □

Series Code
 MA: Double Action Type
 MSA: Single-Extrusion Type
 MTA: Single Drawing-in Type
 MAD: Double-shaft Double Action Type
 MACD: Double-shaft Double Action Damping Type
 MAJ: Double-shaft and Adjustable Stroke Type
 MAC: With Cushion Type

Back Cover Type
 Blank: Fishtail type
 CM: Rounded type
 U: Horizontal type

Cylinder Bore
 32mm-63mm

Stroke
 0~100mm

Adjustable Stroke Type
 0~100mm

Magnet Code
 Blank: Without Magnet
 S: With Magnet

Fixed Type
 Blank: Normal type
 LB: Front and back fixed type
 FA: Front cover fixed type
 SDB: Back cover swinging type

Overall Dimensions

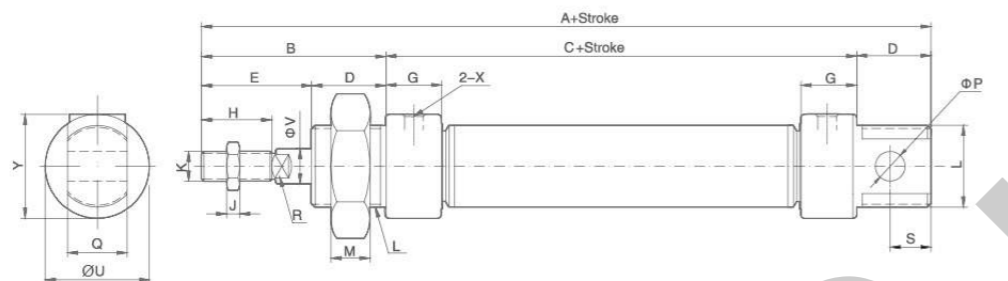

Dimension Sheet

Bore/Symbol	A	B	C	D	E	G	H	M	J	K	P	S	R	U	V	Q	Y	K	X
32	160	57	76	27	30	16	22	8	6	M10×1.25	10	12	10	35	12	16	35	M24×2	G1/8
40	162	57	76	27	32	16.7	24	8	7	M12×1.25	12	12	14	41.6	16	16	41.6	M30×2	G1/8

Overall Dimensions

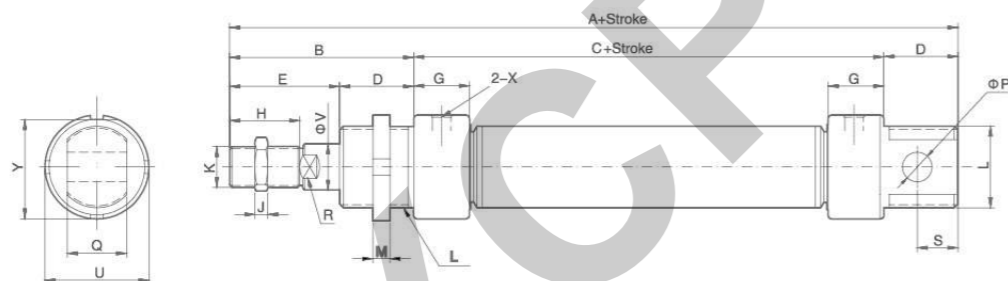

Dimension Sheet

Bore/Symbol	A	B	C	D	E	G	H	M	J	K	P	S	R	U	V	Q	Y	K	X
50	200	73	94	33	40	22	32	8	8	M16×1.5	16	15	17	57	20	21	55	M45×1.5	G1/4
63	203	73	97	33	40	22	32	8	8	M16×1.5	16	15	17	70	20	21	68	M45×1.5	G1/4

Our Company can also make FST type (ISO 6432) 32-63 bore cylinder. If you require this, it should be specified.

MA Series Stainless Steel Mini Cylinder



MA 25 x 50



MAJ 25 x 50-25

Ordering Code

MA □ 20 × 50 - 25 - S - □

Series Code
 MA: Double Action Type
 MSA: Single Extrusion Type
 MTA: Single Drawing-in Type
 MAD: Double-shaft Double Action Type
 MACD: Double-shaft Double Action Damping Type
 MAJ: Double-shaft and Adjustable Stroke Type
 MAC: With Cushion Type

Back Cover Type
 Blank: Fishtail type
 CM: Rounded type
 U: Horizontal type

Cylinder Bore
 16mm~40mm

Stroke
 0~100mm

Adjustable Stroke Type
 0~100mm

Magnet Code
 Blank: Without Magnet
 S: With Magnet

Fixed Type
 Blank: Normal type
 LB: Front and back fixed type
 FA: Front cover fixed type
 SDB: Back cover swinging type
 U: Back cover fixed type

Internal structure

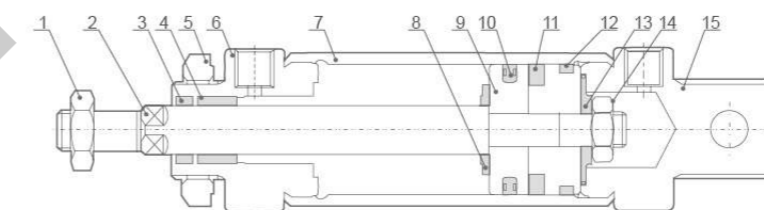

NO	Designation	NO	Designation
1	Piston Rod Nut	9	Piston
2	Piston Rod	10	Piston O-Ring
3	Front Cover Seal Ring	11	Magnet(Optional)
4	Oiled Bearing	12	Wear ring
5	Front Cover Nut	13	Back cushion
6	Front Cover	14	Hex socket screw
7	Stainless steel tube	15	Back Cover
8	Anti-crash cushion		

Specification

Bore(mm)	16	20	25	32	40
Motion Pattern	Double Action or Single Action				
Working Medium	Air				
Fixed Type	Normal Type LB Type FA Type SDB Type U Type				
Operating Pressure Range	0.1~0.9MPa				
Ensured Pressure Resistance	1.35MPa				
Operating Temperature Range	-5~70℃				
Operating Speed Range	50~800mm/s				
Buffer Type	Standard Type	Anti-crash cushion			
	Damping Type	Adjustable cushion			
Port Size	M5×0.8	G1/8"	G1/8"	G1/8"	G1/8"

Our Company can also make flat for cylinder covers inlet and outlet position. If you require this, it should be specified.

Stroke

Bore(mm)	Standard Stroke										Max.Stroke(mm)	Permissible Stroke			
16	25	50	75	80	100	125	160	175	200		300	500			
20	25	50	75	80	100	125	160	175	200	250	300	500			
25	25	50	75	80	100	125	160	175	200	250	300	350	400	450	500
32	25	50	75	80	100	125	160	175	200	250	300	350	400	450	500
40	25	50	75	80	100	125	160	175	200	250	300	350	400	450	500