

HAD402 series Auto Drain



HAD402-04



Graphic Symbol

Specification

Model	HAD402-02	HAD402-03	HAD402-04
Ensured Pressure Resistance	1.5MPa		
Operating Pressure	0.15MPa~1.00MPa		
Ambient and Fluid Temperature	5~60℃		
Port Size	G1/4"	G3/8"	G1/2"
Drain Bore	G1/8"		
Drain Status	Normal Open type		
Working Medium	Compressed Air		

Overall Dimensions

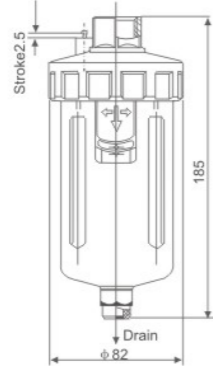

Range of Application:

This product often applies to auto remove the see per at the lower places of piping, frozen type air drying machine. Oil separator, air storage tanks and the bottom of various air filters. It can be installed in the places inconvenient for manual discharge of sewage, such as higher, lower and narrow places, especially there slarge consumption of air or frequent water drains. It can prevent the compressed air being re-polluted by con-dense water resulting from neglect of manual drain.

Features:

Auto Drain/Air Shutoff Drain/Manual Drain
The water cup is provided with metal protective cover

Points for Attention:

When using, the drainer should be installed vertically the drain port facing down

SAH402 series High Pressure Auto Drain



SAH402-04



Graphic Symbol

Specification

Model	SAH402-02	SAH402-03	SAH402-04
Ensured Pressure Resistance	2.5MPa		
Operating Pressure	0.15MPa~2.00MPa		
Ambient and Fluid Temperature	5~60℃		
Port Size	G1/4"	G3/8"	G1/2"
Drain Bore	G1/8"	G1/4"	G3/8"
Drain Status	Normal Open type		
Working Medium	Compressed Air		

Overall Dimensions

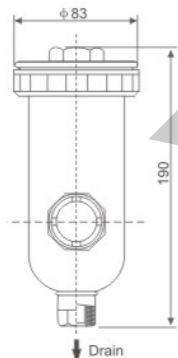

Range of Application:

This product serves as a drainer for high-pressure air source system and functions to divert water for the whole pipeline system. It is generally used for the equipment inconvenient for manual discharge of water or comparatively high frequency of water discharge such as the low spots of pipeline, freezing type air drier and the water deposit place of air chamber etc.

Features:

Auto Drain
Metal protective cover with view window

Points for Attention:

When using, the drainer should be installed vertically the drain port facing down.

XADV Series Auto Drain



XADV 300-FN



XADV 300-FW

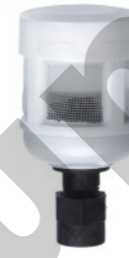

XADV 400-FN(BC-FN)



XADV 400-FW(BC-FW)



XADV 200-G10(AC-G10)



XADV-MA-G14



XADV 400-G12
(XADV BC-GN16)



XADV 300-G12
(XADV 300-G14)

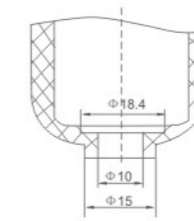

XADV-200(AC)

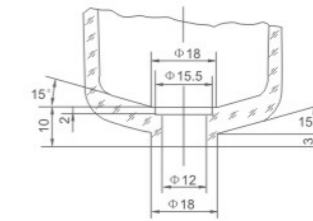

ADV-300

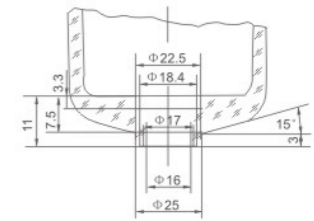

XADV-(BC)

Ordering Code

XADV	200	FN/W
Series XADV Series	Machine Type 200 Series 300 Series 400 Series BC Series	Drain Principle F: Floating ball Type N: Female Thread W: Male Thread

Ordering Code

XADV	200	G10
Series XADV Series	Machine Type 200 Series 300 Series 400 Series BC Series MA Series AC Series	Drain Principle G: Level Type(10,12,14,16 Number Stands for inner diameter of equipped water cup)

Range of Application:

This product is installed at the bottom of water cups for auto dischargers, air filters and air filter regulators and can auto discharge the condense water gathered in the water cup.

Technical Requirements:

Working medium: Compressed air
Ambient and media temperature: 5~60℃
Operating pressure range: 0.15~1.00Mpa

Features:

Auto drainer/Air Shut off Drain/Manual Drain

Points for Attention:

When using, the drainer should be installed vertically the drain port facing down.

Dimensional Drawing of Water Cup Connecting Part

XADV Series Auto Drain

Overall Dimensions

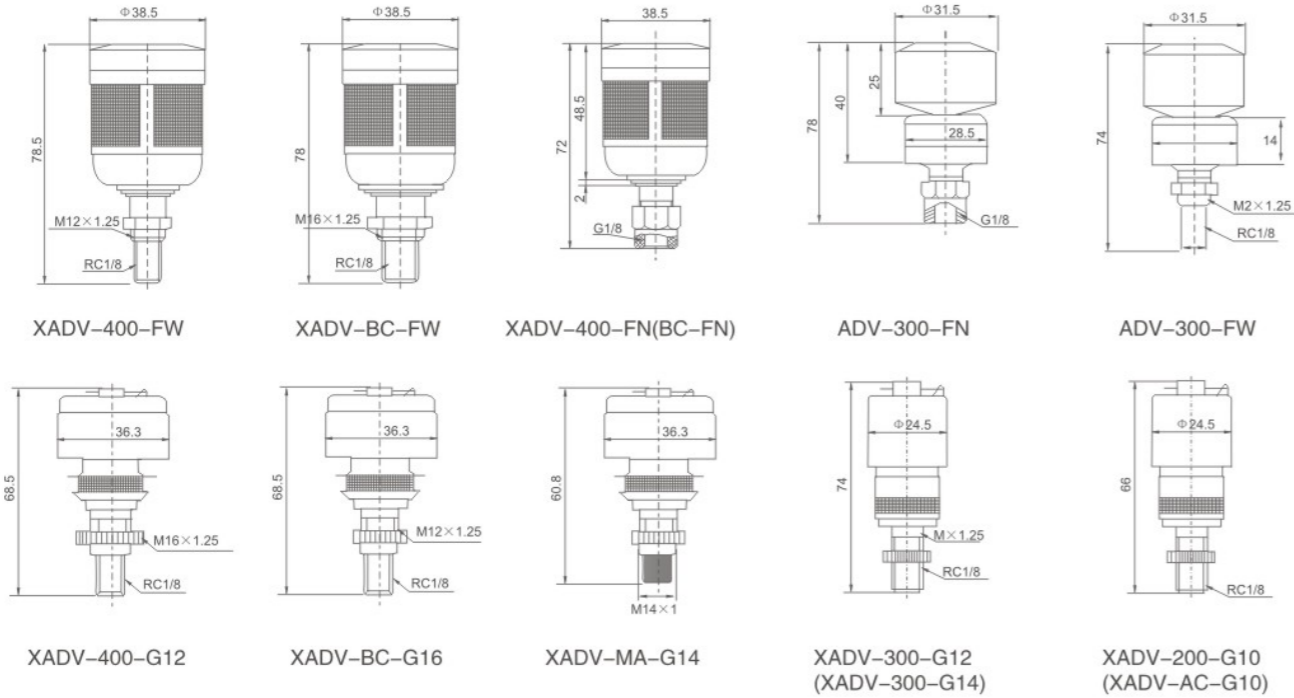

XO Series Air Unit Accessories

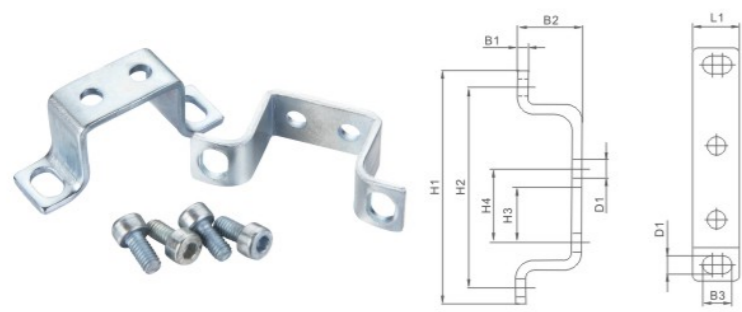

Dimension Sheet

Model	B1	B2	B3	D1	H1
OHC-MINI	2	19	7.3	4.3	43
OHC-MIDI/MAXI	3	19	8.3	5.3	70

Model	H2	H3	H4	L1
OHC-MINI	35	5.5	11	12
OHC-MIDI/MAXI	60	16.5	22	14

Mounting Bracket OHC

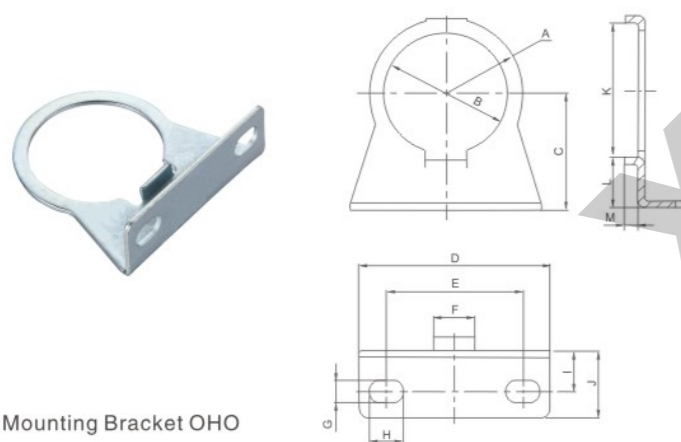

Dimension Sheet

Model	A	B	C	D	E	F	G
OHO-MINI/MAXI	22.5	36.5	35	56	40	12	6.5
OHO-MIDI/MAXI	30	52.5	48	70	53	12	8.5

Model	H	I	J	K	L	M	N
OHO-MINI/MAXI	10	12	20	40.4	15	4	2
OHO-MIDI/MAXI	10.5	17.5	27	55.5	20	4	2

Mounting Bracket OHO

XO Series Air Unit Accessories

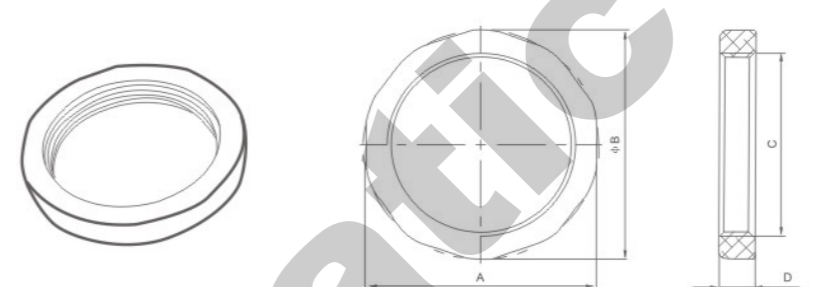

Nut HMR

Dimension Sheet

Model	A	B
HMR-MINI/MAXI	44	45
HMR-MIDI	60	62

Model	C	D
HMR-MINI/MAXI	M36x1.5	7
HMR-MIDI	M52x1.5	8

Specification

Model	Normal size	Pneumatic connection	Indicating range
OMA-10-1/8	40	G1/8	0-10 bar
OMA-16-1/8			0-16 bar
OMA-10-1/4	50	G1/4	0-10 bar
OMA-16-1/4			0-16 bar



Pressure Gauge OMA

The Pressure gauge is used to measure and display the pressure of the control system.

XA Series Air Unit Accessories



Bracket for AR/AW

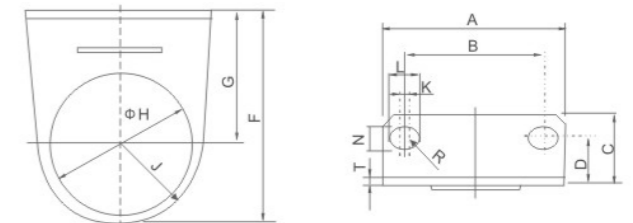

Dimension Sheet

Model	A	B	C	D	F	G	ΦH	J	K	L	N	R	T	Applicable Model
B120	40	28	17	11	37.8	25	20.5	12.3	2	6.5	4.5	2.25	2	AR/AW1000
B220	55	34	25	19	50	30	33.5	20	10	15.4	5.4	2.7	2.3	AR/AW2000/AR2500
B320	53	40	21.5	14	64	39	42.5	25	1.5	8	6.5	3.25	2.3	AR/AW3000
B420	70	54	27	18	79.2	49.2	52.5	30	2	10.5	8.5	4.26	2.3	AR/AW4000-5000



Bracket for AL/AF

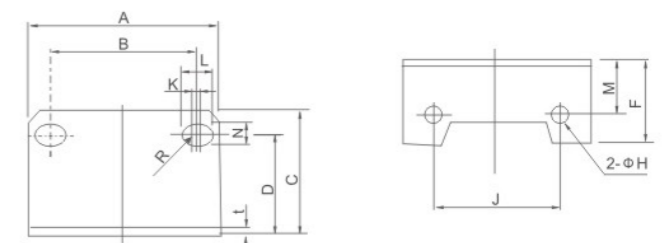

Dimension Sheet

Model	A	B	C	D	F	G	ΦH	J	K	L	N	R	t	Assembly Screw	Applicable Model
B240	40	27	33	27	18	4.5	26	3	8.4	14	5.4	2.7	2.3	M4×8	AF/AL2000
B340	53	40	39	32	22.5	4.5	35	1.5	8	19	6.5	3.25	2.3	M4×8	AF/AL3000
B440	70	54	47	38	31.5	5.5	47	2	10.5	20	8.5	4.25	2.3	M5×10	AF/AL4000
B540	70	54	47	38	27.5	5.5	47	2	10.5	20	8.5	4.25	2.3	M5×10	AF/AL4000-06
B640	90	66	64	52	43	6.5	60	2	13	29	11	5.5	3.2	M6×10	AF/AL5000