

**VX Series 2/2 Solenoid Valve**



Ordering Code

**VX2120** — **08** — **AC220V**

Specification Code

Port Size  
06:G1/8"  
08:G1/4"  
10:G3/8"  
15:G1/2"

Standard Voltage  
DC12V DC24V  
AC24V 50Hz/60Hz  
AC110V 50Hz/60Hz  
AC220V 50Hz/60Hz  
AC380V 50Hz/60Hz

Graphic Symbol

Specification

Model	VX2120-06	VX2120-08	VX2120-10	VX2120-15
Working Medium	Air, Water, Steam			
Motion Pattern	Direct Drive Type			
Type	Normal Close Type			
Working-pressure	0~1.0MPa			
Aperture of Flow Rate(mm)	3		10	13
Port Size	G1/8"	G1/4"	G3/8"	G1/2"
Operating Temperature Range	-5~+150°C		-5~+80°C	
Material of Oil Seal	VITON		NBR	

Internal structure

NO	Code	Name
1	VX2120-06-01	Body Of Valve
2	VX2120-06-02	Assembly Of Iron Core
3	VX2120-06-03	O-ring
4	VX2120-06-04	Assembly Of Iron Core
5	VX2120-06-05	Spring
6	VX2120-06-06	Spring
7	VX2120-06-07	Coil
8	VX2120-06-08	Name Plate
9	VX2120-06-09	Clip

Overall Dimensions

Dimension Sheet

Model	Port	A	B	C
VX2120-06	G1/8"	26	40	66
VX2120-08	G1/4"	26	40	66
VX2120-10	G3/8"	40	48	80
VX2120-15	G1/2"	47	66	88

**VXF Series Solenoid Valve**



Ordering Code

**VXF2150** — **06** — **AC220V** — □

Specification Code

Port Size  
06:G3/4"  
10:G1"  
14:G1/2"

Standard Voltage  
DC12V DC24V  
AC24V 50Hz/60Hz  
AC36V 50Hz/60Hz  
AC110V 50Hz/60Hz  
AC220V 50Hz/60Hz  
AC380V 50Hz/60Hz

Wiring Form  
Blank:Lead  
Wire Type  
D:Joint  
Connector

Graphic Symbol

Specification

Model	VXF2150-06	VXF2160-10	VXF2280-14
Port Size	G3/4"	G1"	G1/2"
Max. Operating Differential Pressure	1.0MPa		
Min. Operating Differential Pressure	0.031MPa		
Section (mm)	20	27	40
Effective Area of Section	170	330	810
CV Value	9.5	18.5	45
Exhaust Orifice	Rc(PT)1/4		

Overall Dimensions

Dimension Sheet

Model	A	B	C	D	E	F	G	H	I	J	K	L	P
VXF2150	33	40	85	32.5	36	66	25	103	110	20	23	30	G3/4"
VXF2160	37	48	89	38	45	74	33.5	118	125	20	23	30	G1"
VXF2280	28	68	81	58	110	110	62.5	174	184	23	25	35	G1-1/2"

**VXF Series Solenoid Valve**

Internal structure

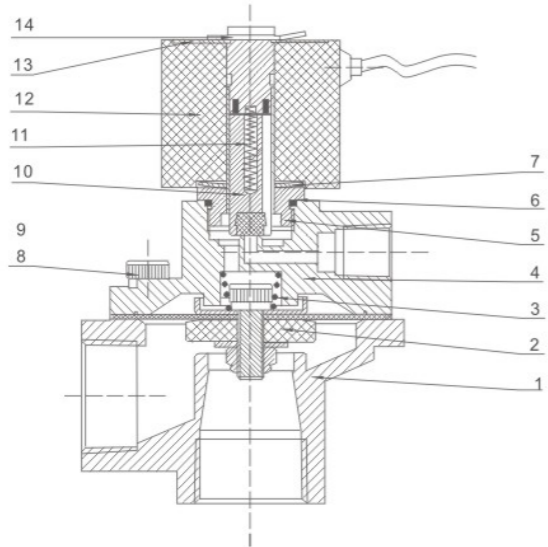

NO	Code	Name
1	VXF2150-06-01	Body of Valve
2	VXF2150-06-02	Assembly Of Diaphragm
3	VXF2150-06-03	Pull Spring
4	VXF2150-06-04	Valve Cover
5	VXF2150-06-05	Assembly Of Iron Core
6	VXF2150-06-06	O-ring
7	VXF2150-06-07	Spring
8	GB70-85	Gasket
9	GB859-87	Socket Hexagon Screws
10	VXF2150-06-08	Assembly Of Iron Core
11	VXF2150-06-09	Spring
12	VXF2150-06-10	Coil
13	VXF2150-06-11	Name Plate
14	VXF2150-06-12	Clip

**XC22/23 Series Solenoid Valve**

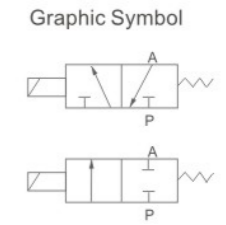

Ordering Code

**XC** — **23** — **06** — **AC220V**

**Factory Code**  
**The Position counting**  
 22: Two position two way  
 23: Two position three way  
**Port Size**  
 06:G1/8"  
 08:G1/4"  
**Standard Voltage**  
 DC12V DC24V  
 AC24V 50/60Hz  
 AC36V 50/60Hz  
 AC110V 50/60Hz  
 AC220V 50/60Hz  
 AC380V 50/60Hz

Specification

Model	XC22-06	XC22-08	XC23-06	XC23-08
Working Medium	Air, Water, Oil			Air
Aperture of Flow Rate(mm)	1.6	2.4	3.2	4.0
CV Value	0.10	0.21	0.33	0.43
Port size	G1/8"	G1/4"	G1/8"	G1/4"
Working-pressure Range	0~1.5	0~1.0	0~0.7	0~0.5
Voltage Range	+10%			
Material of oil seal	NBR or VITON			

Overall Dimensions

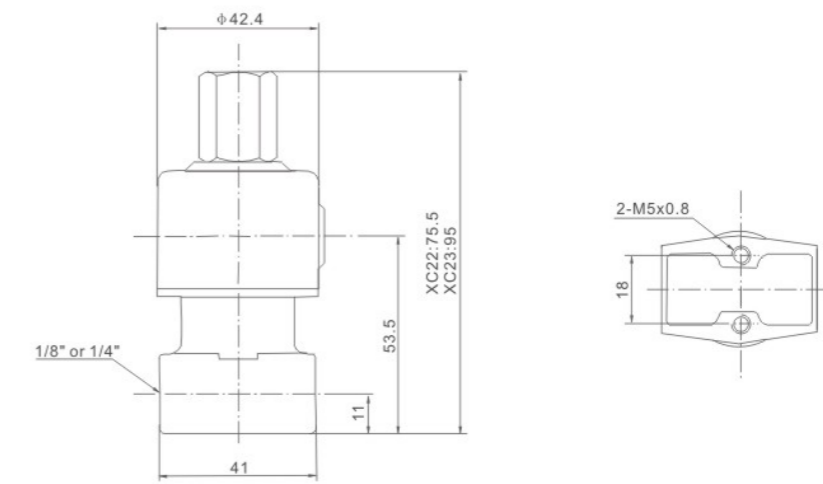

E

E